

## 5-Phase-Stepping Motor [0,72° High-Torque-Version]

Technical drawing of a mechanical part, likely a bearing housing or flange, showing dimensions in millimeters. The drawing includes a side view and a cross-sectional view. Key dimensions include:

- Overall width: 15.5
- Total length: 56.5
- Flange thickness: 20.6
- Mounting hole diameter:  $\varnothing 8 - 0.015$
- Central hole diameter:  $\varnothing 36 - 0.003$
- Distance from mounting hole to center: 15
- Distance from flange face to center: 15
- Distance from flange face to mounting hole: 5
- Distance from flange face to central hole: 1.6
- Distance from mounting hole to central hole: 7.5  $\pm 0.1$
- Distance from flange face to central hole: 7.5  $\pm 0.1$
- Central bore diameter: 305 MIN.

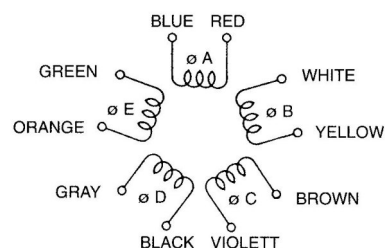
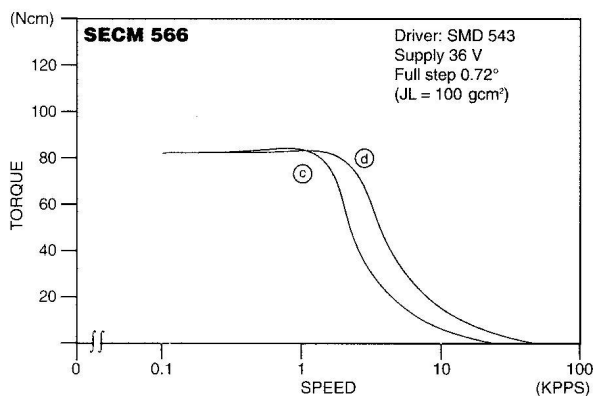
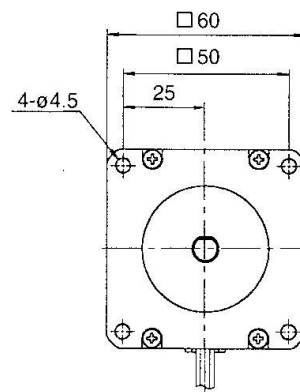

As options, we deliver Encoder and / or Planetary Gears for our Stepping Motors.