

## SECM566er Baureihe

5-Phasen-Schrittmotor

[0,72° High-Torque-Version]

Model	Full Step Angle	Holding Torque (Ncm)	Current/Phase (A)	Resistance/Winding (Ω)	Inductance/Winding (mH)	Voltage DC (V)	Torque/Speed
A = Single Shaft B = Double Shaft							
<b>SECM 566 - T 0.8 A</b> <b>SECM 566 - T 0.8 B</b>	0.72°	83	0.75	3.4	10.0	2.6	Ⓒ
<b>SECM 566 - T 1.4 A</b> <b>SECM 566 - T 1.4 B</b>	0.72°	83	1.40	1.1	3.8	1.5	Ⓓ
Number of Leads	Weight (Kg)		Size Length (mm)		Rotor Inertia (gcm <sup>2</sup> )		
10	0.7		60x60x56.5		220		

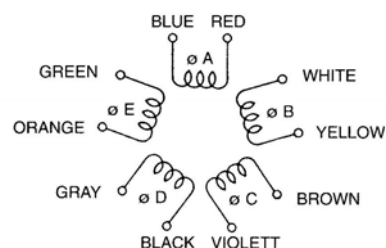
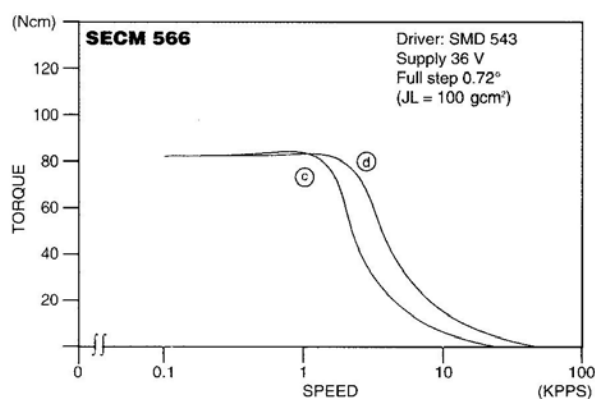
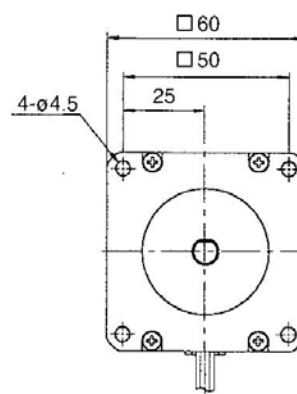
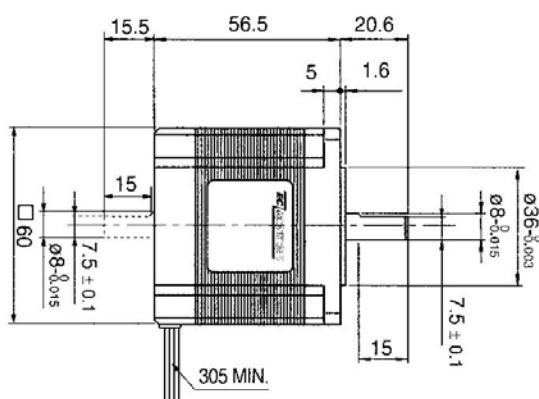

Optional sind für unsere Schrittmotoren Encoder und / oder Planetengetriebe erhältlich.



EC Motion GmbH - Auf den Steinen 20 - 41812 Erkelenz  
Tel.: +49 (0)2164-7014-0 - Fax. : +49 (0)2164-701419  
Internet: www.ec-motion.de - e-mail: info@ec-motion.de

